

EATON COUNTY BOARD OF COMMISSIONERS

RESOLUTION TO APPROVE DCA-7-22-2

**Introduced by the Public Works and Planning Committee
Eaton County**

Commissioner Lautzenheiser moved the approval of the following resolution. Seconded by Commissioner Mott.

PREAMBLE: The Eaton County Land Development Code, an Ordinance adopted by the Commissioners of the County of Eaton pursuant to Public Act 183 of 1943, and administered pursuant to Public Act 110 of 2006, as amended, may be amended from time to time by following procedures outlined in Article 13 of the Development Code.

WHEREAS, Garrett and Kellie Madry initiated a petition to change the Land Development District (zoning) designation for a 20.20 acre parcel located at 11260 Pine Highway, Section 30, Bellevue Township from Low Density Residential (R-1) to Limited Agricultural (LA); and

WHEREAS, the Eaton County Planning Commission held duly advertised and noticed public hearing on **July 5, 2022**; and

WHEREAS, the Eaton County Planning Commission found the requested amendment to be consistent with the required findings of fact (Items A-G) contained in Section 13.6 of the Eaton County Land Development Code; and

WHEREAS, the Eaton County Planning Commission has taken action on **July 5, 2022** to recommend the approval of the request for change in the Land Development District designation.

NOW THEREFORE BE IT RESOLVED that the Board of Commissioners of the County of Eaton, Michigan having considered the findings of facts and recommendations hereby:

APPROVES the request by Garrett and Kellie Madry for a change in land use district classification in Section 7.1.2 of the Land Development Code to change a 20.20 acre parcel located 11260 Pine Hwy, Section 30, Bellevue Township from Low Density Residential (R-1) to Limited Agricultural (LA);

COM. AT SE CORNER OF W 1/2 OF NE 1/4, SW ALONG ROAD 14 RODS, W 26 RODS, N 86 RODS TO 1/8 LINE, E 38 RODS TO 1/8 LINE, S 80 RODS TO BEG. SEC. 30, T1N, R6W. BELLEVUE TWP.

At the regular meeting of the Eaton County Board of Commissioners on **July 20, 2022** the Resolution regarding the approval of said request was adopted.

Those voting Aye: Commissioners Barnes, Mulder, Augustine, Haskell, Pearl-Wright, Whitacre, Mudry, Brehler, Droscha, Reynnet, Ridge, Lautzenheiser, Mott, Rogers and Whittum.

Those voting Nay: None

Abstention: None

Absent: None

Motion carried.

Jeremy Whittum, Chairman
Eaton County Board of Commissioners

I hereby certify that the above Ordinance amending the Eaton County Land Development Code, which was approved, is a true and correct copy of that recorded in the official minutes of **July 20, 2022** of the Eaton County Board of Commissioners.

Diana Bosworth, Clerk
Eaton County Board of Commissioners

**EATON COUNTY LAND DEVELOPMENT CODE
ZONING ORDINANCE AMENDMENT DCA-7-22-2**

District Change Amendment DCA-7-22-2 to amend the Zoning District Maps of the Eaton County Land Development Code (zoning ordinance) of Eaton County, as enacted in 1981 pursuant to the provisions of Public Act 110 of 2006, as amended.

An application for a District Change Amendment to change a Land Development District designation on the Official Land Development District Map (Map Amendment) has been submitted by Garrett and Kellie Madry to rezone a 20.20 acre parcel from Low Density Residential (R-1) to Limited Agricultural (LA) located at 11260 Pine Hwy, Section 30, Bellevue Township parcel 130-030-200-040-00 which is legally described as:

COM. AT SE CORNER OF W 1/2 OF NE 1/4, SW ALONG ROAD 14 RODS, W 26 RODS, N 86 RODS TO 1/8 LINE, E 38 RODS TO 1/8 LINE, S 80 RODS TO BEG. SEC. 30, T1N, R6W. BELLEVUE TWP.

WHEREAS, the Eaton County Planning Commission held duly advertised and noticed public hearing on **July 5, 2022**; and

WHEREAS, the Eaton County Planning Commission has taken action on **July 5, 2022** to recommend approval of the map amendment:

WHEREAS, after careful consideration of the amendment, the Eaton County Board of Commissioners approved the aforementioned map amendment as follows:

Yeas	15
Nays	0
Abstaining	0
Absent	0

I, Diana Bosworth, Clerk for the County of Eaton, do hereby certify that the above and foregoing is a true copy of the amendment to the Zoning District Maps of the Eaton County Land Development Code (Zoning Ordinance), as amended and passed by the Eaton County Board of Commissioners on **July 20, 2022**, and now on record in the office of the Clerk of said County.

IN TESTIMONY WHEREOF, I have set my hand and affixed the seal of said County at the City of Charlotte, Michigan, the

_____ day of _____, 2022

Diana Bosworth, Clerk
Eaton County Board of Commissioners

Jeremy Whittum, Chairman
Eaton County Board of Commissioners

LOW DENSITY RESIDENTIAL (R-1) CHANGED TO LIMITED AGRICULTURAL (LA)

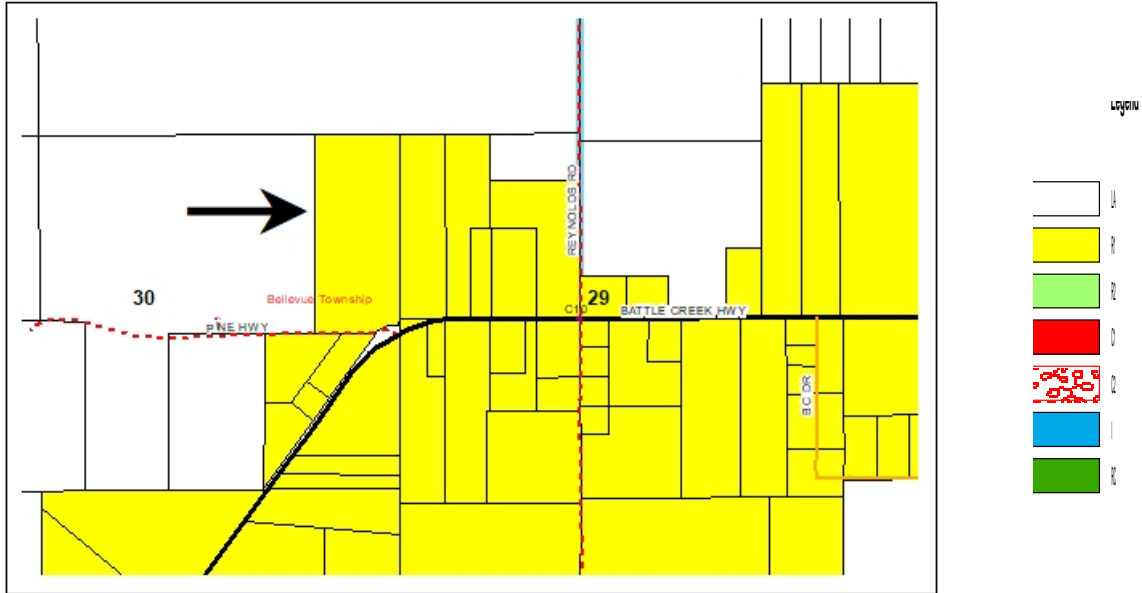

Eaton County
Community Development Department

Permit: DCA-7-22-2
Township: Bellevue



COM. AT SE CORNER OF W 1/2 OF NE 1/4, SW ALONG ROAD 14 RODS, W 26 RODS, N 86 RODS TO 1/8 LINE, E 38 RODS TO 1/8 LINE, S 80 RODS TO BEG. SEC. 30, T1N, R6W. BELLEVUE TWP.

Jeremy Whittum, Chairman
Eaton County Board of Commissioners

Diana Bosworth, Clerk
Eaton County Board of Commissioners

Date: _____

Date: _____

